



ISA and ISPID Joint Conference

SYDNEY AUSTRALIA • 8 – 10 October 2010

*Precious lives: global collaboration
in stillbirth and infant death*



international
stillbirth alliance



ISPID

Pocket Program

Welcome

On behalf of the Conference Organising Committee we take great pleasure in welcoming you all to Sydney, Australia to participate in the inaugural Joint Conference of the International Stillbirth Alliance (ISA) and the International Society for the Study and Prevention of Perinatal and Infant Death (ISPID).

The Conference, “Precious lives: global collaboration in stillbirth and infant death” aims to enhance international collaboration in addressing the global loss of lives through stillbirth and infant death.

We value your participation in this Conference; it is with our collective efforts that the loss of these precious lives will be reduced and the support and care of families suffering this loss will be improved.

October is Pregnancy and Infant Loss Awareness Month all around the world and this Conference will provide an opportunity for bereaved parents to honour and remember their precious babies.

SIDS and Kids Australia, representing ISPID, and the Australian and New Zealand Stillbirth Alliance (ANZSA), ISA’s regional office representing ISA, are both honoured to be co-hosting this exciting event being held at the Masonic Centre in vibrant Sydney.

Spring is one of the best times to visit Sydney! During your stay there will be plenty of opportunities to visit some of Sydney’s iconic sights, including the beautiful Sydney Harbour, Opera House and Sydney’s world famous beaches. We hope you all have a fabulous time during your stay.

We are glad that you have joined us down under at this unique Conference that will bring together world class researchers, health professionals and families from across the globe to share new knowledge and initiatives and to build collaborations towards our common goals.

Kind regards

Leanne Raven & Vicki Flenady
Co-Chairs, Organising Committee



Contents

Committees	4
Location Map	5
Venue Maps	6
General Information	8
Social Functions	10
International Stillbirth Alliance Meeting	12
Program	13
Sponsors & Exhibitors	25

Committees

Organising Committee

Vicki Flenady *Co-Chair ANZSA/ISA*

Leanne Raven *Co-Chair SIDS and Kids/ISPID*

Liz Conway *ANZSA/ISA*

David Ellwood *ANZSA/ISA*

Karen Faichney *SIDS and Kids/ISPID*

Rosemary Horne *SIDS and Kids/ISPID*

Yee Khong *ANZSA/ISA*

Ed Mitchell *SIDS and Kids/ISPID*

Karen Passey *SIDS and Kids/ISPID*

Ros Richardson *SIDS and Kids/ISPID*

Program Committee

Liz Conway *ANZSA/ISA*

Ros Richardson *SIDS and Kids/ISPID*

Vicki Flenady *ANZSA/ISA*

Alison Kent *ANZSA/ISA*

Jeanine Young *SIDS and Kids/ISPID*

Rosemary Horne *SIDS and Kids/ISPID*

Yee Khong *ANZSA/ISA*

David Ellwood *ANZSA/ISA*

Ed Mitchell *SIDS and Kids/ISPID*

Sponsorship/ Exhibition and Marketing Committee

Leanne Raven *SIDS and Kids/ISPID*

Vicki Flenady *ANZSA/ISA*

Deb Boyd *SIDS and Kids/ISPID*

Social Committee

Karen Faichney *SIDS and Kids/ISPID*

Karen Passey *SIDS and Kids/ISPID*

Ros Richardson *SIDS and Kids/ISPID*

Memorial Committee

Ros Richardson *SIDS and Kids/ISPID*

Karen Faichney *SIDS and Kids/ISPID*

Karen Passey *SIDS and Kids/ISPID*

Joint ISA and ISPID 2010

Conference Secretariat

c/- Conexion Event Management

PO Box 601

Pymont NSW 2009

Australia

P: + 61 2 9518 7722

F: + 61 2 9518 7222

E: isaispid2010@conexion.com.au

Location Map



Venue Maps

GROUND FLOOR

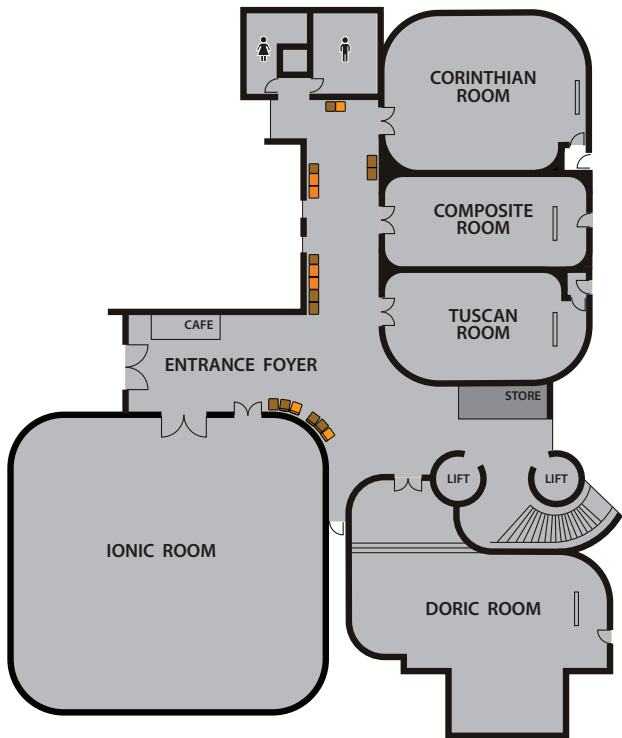

LEVEL 1

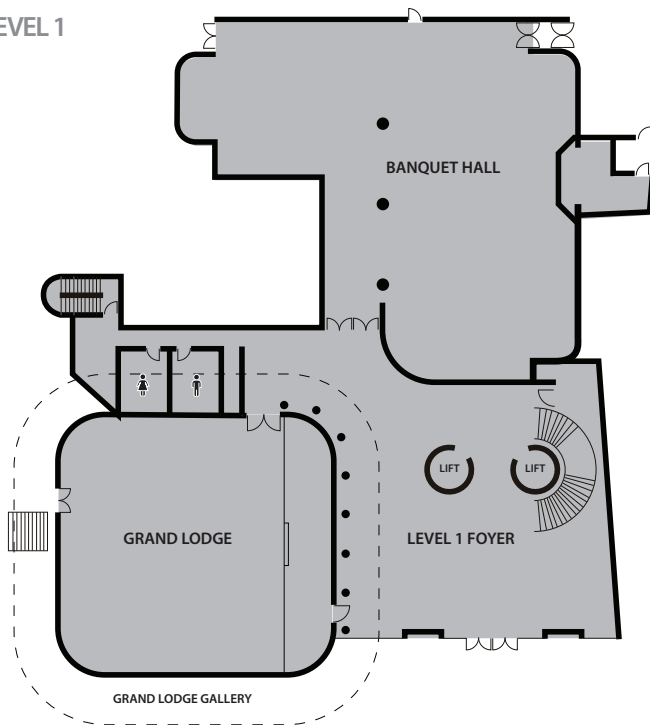

General Information

Accommodation

Please find the contact numbers for the Conference Hotels below. Should you require any assistance during your stay please contact the Concierge at your hotel.

Quest World Square

2 Cunningham Street, Sydney
NSW, 2000

Ph: +61 2 9291 1900

Vibe Hotel Sydney

111 Goulburn Street, Sydney
NSW, 2000

Ph: +61 2 8272 3300

Ibis World Square

382 – 384 Pitt Street, Sydney
NSW, 2000

Ph: +61 2 8267 3111

Sydney Marriott Hotel

36 College Street, Sydney
NSW, 2010

Ph: +61 2 9361 8400

Banks

Banks in Australia are open from 0930 to 1600 Monday to Thursday and 0930 to 1730 on Friday. Select banks are open on Saturday; however, all banks are closed on

Sunday. Automatic Teller Machines (ATM) facilities are located at a variety of outlets throughout Australia. The closest Bank and ATM to the Sydney Masonic Centre is located on George Street.

Medical Assistance

The closest medical centre to the Sydney Masonic Centre is: Medeco Medical Centre World Square 644 George Street
Ph: +61 2 9264 8500

Please ask for assistance at the registration desk if you require any medical attention during the Conference.

Delegate entitlements

Full Delegate Registration

- Attendance at all sessions
- All delegate materials
- Morning Tea (Friday-Sunday)
- Lunch (Friday-Sunday)
- Afternoon Tea (Friday-Sunday)
- Welcome Reception
- Conference Dinner
- Opening Ceremony

Concession Registration

- Attendance at all sessions
- All delegate materials
- Morning Tea (Friday-Sunday)
- Lunch (Friday-Sunday)
- Afternoon Tea (Friday-Sunday)

Day Registration

- Attendance at all sessions on day of registration
- All delegate materials
- Morning Tea on day of registration (Friday-Sunday)
- Lunch on day of registration (Friday-Sunday)
- Afternoon Tea on day of registration (Friday-Sunday)

Name Badge

For security reasons, you must wear your name badge at all times during the Conference. The name badge identifies you as eligible for catering and entry to all Conference sessions. Delegates will be denied entry without a name badge.

Registration

Registration will take place in the Marble Foyer outside the Banquet

Hall of the Sydney Masonic Centre.

The Registration desk will be open during the following times:
Thursday, 7 October: 1700 – 1800
Friday, 8 October: 0700 – 1730
Saturday, 9 October: 0700 – 1730
Sunday, 10 October: 0700 – 1600

Meals and Refreshment

All morning tea, lunch and afternoon tea will be held in the Banquet Hall on the first floor near the Marble Foyer.

Speaker Preparation Room

All speakers will need to check into the Speaker Preparation Room the day prior to your session or on your arrival at the Sydney Masonic Centre. The Speaker Preparation Room is located on the Banquet Hall Balcony (Level 2). A technician will be available to assist you with your presentation upon check-in. Opening dates and times for the Speaker Preparation Room are as follows:

8 – 10 October: 0800 – 1730

Social Functions

Parking

Parking facilities are available at the Wilson Parking Station on the corner of Castlereagh and Goulburn Streets. Parking costs from \$8 per hour.

Public Transport

Sydney's public transport system allows easy travel for delegates between their hotel and the Conference venue or around Sydney's central business district. Delegates can secure savings on travel throughout the city by purchasing a Day Tripper pass which allows travel on train, bus or ferry from AUD18.20.

Taxis can be booked in advance through hotel concierge or hailed from the street.

Welcome Reception

Date: Thursday, 7 October 2010

Time: 1800 – 1930

Venue: Banquet Hall

Dress: Business Casual

Morning Yoga and Meditation

Date: 8, 9, 10 October 2010

Time: 0700 – 0745

Venue: Tuscan Room

Dress: Loose and comfortable exercise wear

Conference Dinner

Date: Saturday, 9 October 2010

Time: 1930 – 2330

Venue: Harbours Edge Event Centre
Darling Harbour

Address: Level 2, Harbourside Shopping Centre, Darling Drive Darling Harbour. (entrance is from the southern end of the centre closest to the Convention Centre)

Dress: Cocktail

During the Conference Dinner the following awards will be presented:

- ISPID & ISA New Investigator Awards
- ISPID & ISA Distinguished Researcher Awards
- ISPID & ISA Health Educator Awards
- ISA Parent Advocate Award



Point of Sale and Retail **fundraising** that delivers



If you're after serious fundraising results with an efficient fundraising product campaign that has excitement and fun at its heart, your Not-For-Profit (NFP) Organisation will benefit from our experienced pro-bono creative services. We offer:

- A great return on investment with returns 3 - 10 times that of the purchase price
- Promotional campaign advice, free design and artwork
- Compliance with International quality control and safety standards
- Dedicated project management from conception to completion

Dragon Trend is an International leading and award-winning supplier of promotional products and promotional advice to NFP's such as SIDS & Kids, RSPCA, Guide Dogs Australia and Inner Wheel Australia. Our long-term relationships with multi-national NFP's mean that we understand the goals, processes and deliverables required when it comes to successful fundraising campaigns.

Passionate about philanthropy and at the forefront of innovative fundraising initiatives, we offer more than 15 years' corporate experience, due diligence and buying power to help NFP's generate funding with minimal risk and effort. There is nothing we enjoy more than seeing NFP's like yours provide the services that our communities so desperately need.

Contact us today

sales@dragontrend.com
www.dragontrend.com

 DRAGON TREND

Australia • Hong Kong • UK

International Stillbirth Alliance Meetings

The following meetings will take place during the conference.

ISA General Assembly

Date: *Friday, 8 Oct 2010*

Time: 1230 – 1330

Venue: *Corinthian Room*

Chair: *A/Prof Vicki Flenady*

The ISA General Assembly is an opportunity for ISA's member organisation to meet to discuss the past year's activities and explore ISA's direction for the following year. The ISA 2010/2011 Board will also be elected here. All members are invited to attend.

ANZSA Annual General Assembly

Date: *Saturday, 9 October 2010*

Time: 1300 – 1400

Venue: *Corinthian Room*

Chair: *Prof David Ellwood*

ANZSA, as the sum of its individual supporters and member organisations invites members to reflect on the years achievements and look forward to the new projects 2011 will bring.

Classification of perinatal mortality

Date: *Sunday, 10 October 2010*

Time: 1300 – 1400

Venue: *Tuscan Room*

Chairs: *Dr Adrian Charles, A/Prof Vicki Flenady, Prof Jason Gardosi and Dr Jan Jaap Erwich.*

Over the last year, from ISA 2009, new initiatives have been developed towards a globally working classification system(s). These developments will be discussed, including the current state of the MAIN classification, WHO initiatives towards new ICD coding, translation of other systems into MAIN, comparison issues between countries/systems, value of verbal autopsy. Participants will be updated on these issues and are invited to share their views on how to proceed.

Program

**Please note the numbers in brackets relate to the published abstracts*

Thursday 7 October 2010

1700-1800 REGISTRATION OPENS

1800-1930 **Welcome Cocktail Reception**

Sydney Masonic Centre, Banquet Hall

Friday 8 October 2010

THE GRAND LODGE

0845-0900 **Welcome Ceremony**

Opening Address by Governor General, Ms Quentin Bryce AC

0900-1030 **Plenary Session 1 Perinatal and Infant Deaths:
A Global Perspective**

Chair: A/Prof Vicki Flenady & Leanne Raven

0900 Making stillbirth a priority (2) *Dr Frederik Frøen*

0920 Stillbirths – where, when, why (1) *Dr Joy Lawn*

0940 Parent's perspective across stillbirth and infant death (3)
Ros Richardson

1000 SIDS/SUDI an international perspective (4) *Dr Peter Blair*

1020 Question Time

1030-1100 **Morning Tea**

1100-1230 **New Investigator Award Presentations**

Chair: A/Prof Rosemary Horne & A/Prof Alison Kent

1100 Maternal sleep position: a potential modifiable risk factor
for third trimester stillbirth (21) *Tomasina Stacey*

1115 Hypoxia related morphological abnormalities in villous
trophoblast turnover in placentas from victims of SIDS (22)
Katie Widdows

- 1130 Bereaved mothers using internet peer support message boards for pregnancy loss: an internet survey of user characteristics and depressive symptoms (23) *Katherine J. Gold*
- 1145 The dummy debate – does dummy use affect infant arousability from sleep? (24) *Heidi Richardson*
- 1200 Does sleeping position effect baroreflex sensitivity in infants? Implications for Sudden Infant Death Syndrome (25) *Stephanie Yiallourou*
- 1215 Risk factors for perinatal death in the Eastern Highlands, Papua New Guinea (PNG) (26) *Bronwen Morrison*

1230-1345		Lunch		
1345-1530	IONIC ROOM	CORINTHIAN ROOM	THE GRAND LODGE	
	1A - Clinical Practice <i>Chair - Prof Jan Jaap Erwich</i>	1B - Physiology <i>Chair - A/Prof Rosemary Horne</i>	1C - Epidemiology <i>Chair - Prof Barry Taylor</i>	
1345	Implementation of Nationwide Perinatal Audit impact on professionals (27) <i>Prof Jan Jaap Erwich</i>	What can we learn about SIDS from physiological studies in healthy infants? (36) <i>A/Prof Rosemary Horne</i>	Identifying and testing safer environments for infant co sleeping in New Zealand (45) <i>Prof Barry Taylor</i>	
1405	Confidential Enquiries into perinatal deaths: a regional programme to identify upstream causes (28) <i>Jason Gardosi</i>	Autonomic dysregulation after prenatal exposure to nicotine in newborn rats (37) <i>Jane Blood-Siegfried</i>	The relationship between bed-sharing and breastfeeding: A longitudinal population-based latent class analysis (46) <i>Peter Blair</i>	
1415	A 12 year audit of neonatal deaths not admitted to neonatal nurseries in a tertiary perinatal hospital (29) <i>David Tudehope</i>	Decreased Arousability in ALTE Infants (227) <i>Patricia Franco</i>	Postnatal parental smoking is an important risk factor for SIDS (47) <i>Germaine Liebrechts-Akkerman</i>	

	IONIC ROOM	CORINTHIAN ROOM	THE GRAND LODGE
1425	Infants on the CONI PLUS programme as a result of an ALTE: A High risk group (30) <i>Alison Waite</i>	Prone sleeping reduces cerebral oxygenation in healthy term infants (39) <i>Rosemary Horne</i>	Incidence and risk factors of fetal death in Norway (48) <i>Linda Björk Helgadóttir</i>
1435	A Questionnaire Study of UK Obstetricians, Midwives' and Perinatal Pathologists' Knowledge and Practice Regarding Postmortem after Stillbirth (31) <i>Alexander Heazell</i>	Oxygen desaturation events during overnight sleep in bedsharing and cot-sleeping infants (40) <i>Sally Baddock</i>	Maternal perception of decreased fetal movements: association with fetal growth restriction (49) <i>Vicki Flenady</i>
1445	MSOAP Outreach Obstetric Training in Western Australia Improved Perinatal Outcomes (32) <i>Belinda Gail Jennings</i>	Prenatal exposure to ethanol blunts arousal during exposure to intermittent hypoxia (41) <i>Robert Darnall</i>	Epidemiology of stillbirth in low and middle income countries (50) <i>Elizabeth McClure</i>
1455	Improving sudden unexplained infant death investigation practices: an evaluation of US training academies (33) <i>Lena Camperlengo</i>	Car Safety Seat use in the First Six Weeks of Life in Full Term Infants (42) <i>Christine McIntosh</i>	Sudden unexplained death in childhood: An epidemiological profile (51) <i>Cliona McGarvey</i>
1505	Harper's story: Teaching midwifery students about stillbirth (34) <i>Alison Homer</i>	Longitudinal home assessment of oxygen saturation in preterm and full term infants during the first six months of age (43) <i>Carl Hunt</i>	Stillbirth, maternal obesity and fetal growth restriction (52) <i>Jason Gardosi</i>

	IONIC ROOM	CORINTHIAN ROOM	THE GRAND LODGE
1515	Information and Communication with Parents About Autopsy for their Stillborn Baby (35) <i>Dell Horey</i>	Circadian Rhythm Development related to Sleeping Patterns in Human Infants (44) <i>Desaline Joseph</i>	Is there still a role for a Birth Score and intervention programmes to reduce infant mortality? (53) <i>Robert Coombs</i>

1530-1600

Afternoon Tea

THE GRAND LODGE

1600-1730 Plenary Session 2 - Coping with Loss

Chair: Line Christoffersen

1600 Understanding Grief Emotions (5) *Dr Peter Barr*

1620 Bereavement Care Practices: A UK Perspective (6) *Dr Janet Scott*

1640 Thoughts from the Land of the Long White Cloud (8)
Dr Vicki Culling

1700 Question Time

1730-1830 Memorial Ceremony

Ionic Room, Sydney Masonic Centre

Saturday 9 October 2010

0700-0830	Safe Sleeping Environment Breakfast Session <i>Adjunct Prof Jeanine Young</i>	Supporting Families and Carers After Stillbirth Breakfast Session
-----------	--	---

THE GRAND LODGE

0900-1030 Plenary Session 3 - Priorities in Future Research Directions

Chair: Prof David Ellwood & Prof Carl Hunt

0900 Research Priorities in Maternal and Infant Health (9)
Prof Robert Pattinson

- 0920 Predicting Stillbirth (10) *Prof Gordon Smith*
- 0940 Reducing stillbirths and infant deaths among Indigenous women (11) *Philippa Middleton*
- 1000 Reducing the risk of unexpected infant deaths: what advice should we give, and what other effects might it have? (12) *Prof Peter Fleming*

1020 Question Time

1100-1245	IONIC ROOM	CORINTHIAN ROOM	THE GRAND LODGE
	2A - Epidemiology <i>Chair - A/Prof Vicki Flenady</i>	2B - Breaking the Silence on Pregnancy Loss and Infant Death <i>Chair - Liz Conway</i>	2C - International Perspectives <i>Chair - Leanne Raven</i>
1100	Reducing Stillbirth in High-Income Countries (54) <i>A/Prof Vicki Flenady</i>	Questions and Answers (63) <i>Liz Conway</i>	Maternal and Perinatal Health 2010: a global view (72) <i>Prof Heather Jeffery</i>
1120	Bradford infant care study (bradics): infant care and SIDS prevention in ab-ethnic population (55) <i>Eduardo Fernandez Moya</i>	Losing contact with one's unborn baby – Mothers' experiences prior to receiving news that their baby has died in utero (64) <i>Mari-Cristin Malm</i>	Reducing the Risk of SIDS in Aboriginal Communities (73) <i>Shauna Lindy Gaebler</i>
1130	Identifying Stillbirths from Three New South Wales Record Linked Population Health Data Sets, 2001-2005 (56) <i>Camille Raynes-Greenow</i>	Supporting Parents in Grief Through a "Help Yourself Concept" (65) <i>Marie Herou</i>	SIDS amongst urban Aboriginal infants – is it more than putting baby to sleep the right way? (74) <i>Jennifer Knight</i>

	IONIC ROOM	CORINTHIAN ROOM	THE GRAND LODGE
1140	When We Say SIDS What Do We Mean? (57) <i>Ian Mitchell</i>	What about the Children? (66) <i>Jane Warland</i>	The maternal, antenatal, intrapartum & neonatal (MAIN) classification system for perinatal death (75) <i>Jason Gardosi</i>
1150	Cramér's Theorem proves all SUDI are SIDS and not a collection of different causes of death (58) <i>David Mage</i>	A bereaved father (67) <i>Steve Younis</i>	Stillbirth prevention in high income countries: population attributable risk for risk factors (76) <i>Laura Koopmans</i>
1200	Causes of stillbirth in Vietnam: comparison of two classification systems (59) <i>Jane Hirst</i>	To survive the loss of a child (68) <i>Björn Törnwall</i>	Neonatal admission and mortality in Kanombe Hospital in Rwanda (77) <i>Judy Orikiiriza</i>
1210	Intimate partner violence and potentially preventable single and recurrent spontaneous fetal loss in an African Setting (60) <i>Amino Alio</i>	Am I Still a Mother?: Making Meaning of Motherhood Following Stillbirth, Neonatal and Infant Loss (69) <i>Vicki Culling</i>	Community perceptions, beliefs and practices on stillbirth in Sekondi/Takoradi (78) <i>Linda Vanotoo</i>
1220	Analysis and Prevention of Neonatal Sudden Unexpected Deaths in NSW (61) <i>Lucia Wang</i>	Lucina survey: knowledge, thoughts and emotions of Italian midwives on stillbirth management (70) <i>Claudia Ravaldi</i>	Reducing infant mortality in a traditional Arab population in Southern Israel : A community-based project (79) <i>Ilana Shoham-Vardi</i>

	IONIC ROOM	CORINTHIAN ROOM	THE GRAND LODGE
1230	Maternal and Perinatal Risk Factors in a South Australian SIDS Cohort (62) <i>Paul Goldwater</i>	Is the death of a child just another day at work for the ambulance crew? (71) <i>Peter Johansen</i>	Evaluation of baby help, an illness assessment tool for Indigenous infants (183) <i>Karen Watson</i>

1245-1400

Lunch

THE GRAND LODGE

1400-1530 **Plenary Session 4 - Genetic Factors, Vulnerability and Infection**

Chair: Prof Gordon Smith & Prof Lesley McCowan

- 1400 Infection and SUDI/SIDS: Possible Links to Stillbirth (13) - *Prof Caroline Blackwell*
- 1420 Genetic Factors in SUDI/SIDS (14) *Prof Debra Weese-Mayer*
- 1440 Update on SUDI/SIDS Risk Factors (15) *Prof Ed Mitchell*
- 1500 Predicting Preterm Birth (16) *Prof Roger Smith*
- 1520 Question Time

1530-1600

Afternoon Tea

1600-1730 Poster Session - BANQUET HALL

1930-2330 **Conference Dinner**
HarboursEdge

Sunday 10 October 2010

0900-1045	IONIC ROOM	CORINTHIAN ROOM	THE GRAND LODGE
	3A - Pathology <i>Chair - Dr Jhodie Duncan</i>	3B - Speaking from the Heart; Parent and Professional Wisdom <i>Chair - Sherokee Ilse</i>	3C - Health Promotion <i>Chair - Adjunct Prof Jeanine Young</i>
0900	Brainstem Serotonergic Deficiency in Sudden Infant Death Syndrome (81) <i>Dr Jhodie Duncan</i>	Speaking from the Heart: Parent and Professional Wisdom (90) <i>Sherokee Ilse</i>	Sustainable Support for Health Professionals Delivering Evidence-based Safe Sleeping Messages to Families: A Multi-Agency Approach (99) <i>Adjunct Prof Jeanine Young</i>
0920	Pre-natal obstetric risk factors and their association with SIDS: morphological evidence of aberrant placental villous trophoblast turnover (82) <i>Katie Widdows</i>	Healing Our Mob (91) <i>Shauna Lindy Gaebler</i>	Improving uptake of safe infant sleeping recommendations: teaching tools for parents and health professionals (100) <i>Alison Williams</i>
0930	Nicotinic Acetylcholine Receptors (a7 and b2) in the brainstem of Sudden Infant Death Syndrome (SIDS) and relationship to smoke exposure (83) <i>Rita Machaalani</i>	The Holding Time: Support for families experiencing the death of their baby (92) <i>Deborah De Wilde</i>	Creating an internet resource for parents seeking advice during pregnancy and after a baby has died (101) <i>Sue Hale</i>

	IONIC ROOM	CORINTHIAN ROOM	THE GRAND LODGE
0940	The role of human cytomegalovirus in stillbirth (84) <i>Stuart Hamilton</i>	The Role of Peer Support in Addressing Long-Term Effects of Infant Loss (93) <i>Joan Noonan</i>	"Better Beginnings" – communicating the "Reduce the Risk" message to teenage parents (102) <i>Louisa Mullan</i>
0950	Decreased Fetal Movement is Associated with Reduced Placental Size, Placental Infarction and Increased Syncytial Knots (85) <i>Alexander Heazell</i>	A research-based approach to the development of an information leaflet for bereaved parents (94) <i>Joyce Epstein</i>	Six plus one: communicators on the inside of priority groups (103) <i>Sharon Bennett</i>
1000	SIDS pathology revisited. Organ weights of infants from two continents: evidence of prenatal infection? (86) <i>Bertie Little</i>	The extended role of the SUDI adviser (95) <i>Barbara Wright</i>	Keeping safe in pregnancy project (105) <i>Jane Warland</i>
1010	A review of the umbilical cord as a cause of stillbirth (87) <i>Adrian Charles</i>	Slow Down; Don't Move too Fast. Got to Make Some Memories to Last (96) <i>Sherokee Ilse</i>	Influencing parents beliefs about reducing the risks of cot death (106) <i>Clare Louise Jolly</i>
1020	10 years of sudden unexpected neonatal deaths referred to the Wellington Forensic Service (88) <i>Dawn Elizabeth Elder</i>	Mothers Clinical and Emotional needs During a Subsequent Pregnancy. A Follow up Study (97) <i>Line Christoffersen</i>	Knowledge, attitudes, and practices with regards to swaddling among a low-income U.S. population (107) <i>Rachel Moon</i>

	IONIC ROOM	CORINTHIAN ROOM	THE GRAND LODGE
1030	Free fetal DNA, placental apoptosis and the prediction of placental failure at term (89) <i>Dr Jasjot Kaur</i>		Question Time

1045-1115 **Morning Tea**

	IONIC ROOM	CORINTHIAN ROOM	THE GRAND LODGE
1115-1300	4A Prioritising Stillbirth Research <i>Chair - Prof Yee Khong</i> <i>Please note the times for this session differ to the standard concurrent session timing</i>	4B Gene Environment & Other Issues <i>Chair - A/Prof Karen Waters</i>	4C SUDI & SIDS Research Directions <i>Chair - Prof Brad Thach</i>
1115	1115 - Introduction to establishing global stillbirth research priorities (108) <i>Prof Yee Khong</i>	Serotonin and SIDS (115) <i>A/Prof Karen Waters</i>	Upper Airway Infections, Infant Apnea and SIDS (124) <i>Prof Brad Thach</i>
1135	1125 - Epidemiology research priorities in low and middle income countries (110) <i>Joy Lawn</i>	Bacterial Virulence, Genetic Polymorphisms and SIDS (116) <i>Paul Goldwater</i>	Pacifiers and SIDS risk: would parents change their mind if they knew? (125) <i>Rachel Moon</i>
1145	1140 - Low and middle income countries interventions research priorities (112) <i>Robert Pattinson</i>	Sleep as a Window into Brain Maturation: The Effect of Nidcap Care Versus Traditional Care in the Neonatal Intensive Care Unit (117) <i>Sonia Scaillet</i>	Breastfeeding and reduced risk of SIDS: A Meta-Analysis (126) <i>Fern Hauck</i>

	IONIC ROOM	CORINTHIAN ROOM	THE GRAND LODGE
1155	1155 - High Income countries research priorities (112) <i>Vicki Flenady</i>	Whole Genome Association Study in SIDS Infants (118) - <i>Maria Mechtild</i> <i>Theresia Vennemann</i>	Risk Factors and SIDS: Exploring Changes Over Time (127) <i>Ian Mitchell</i>
1205	1210 - Discovery research priorities (113) <i>Gordon Smith</i>	CMV Infection is Frequently Detected in Stillbirths, In Association with Growth Restriction and Vascular Abnormalities (192) <i>Jenna Iwasenko</i>	Infant Sleep Position, Bedsharing and Pacifier Use In a Population at High Risk for SIDS in the United States (130) <i>Eve Colson</i>
1215	1225 - Moving forward with the global research agenda for stillbirth (114) <i>Robert Goldenberg</i>	Neonatal Screening Card Blood Spots: a Novel Source of DNA for Genetic Analysis in SIDS / Matched Comparison Babies (120) <i>Paul Goldwater</i>	Bed Sharing and the Risk of SIDS: a Discussion Document (128) <i>Maria Mechtild</i> <i>Theresia Vennemann</i>
1225	1245 - Question Time	Can an umbilical cord nucleated red blood cell count be used to identify fetuses that have been chronically stressed before delivery? (178) <i>Samir Rabaa</i>	Targeting high risk populations through low literacy safe sleeping resources (131) <i>Karen Faichney</i>

	IONIC ROOM	CORINTHIAN ROOM	THE GRAND LODGE
1235		Brain-derived Neurotrophic Factor and its receptor TrkB protein expression in the Sudden Infant Death Syndrome (219) <i>Samantha Tang</i>	Industry Clean-Up: Aligning Product Promotion with Safe Sleep Advice (132) <i>David Smith</i>
1245			A program to evaluate the distribution of cribs and delivery of safe sleeping messages to high-risk infants in 2 states and the District of Columbia, USA (201) <i>Nadine Goldberg</i>

1300-1400

Lunch

THE GRAND LODGE

1400-1600 Plenary Session 5 - Call to Action

Chair: Prof Peter Fleming & Prof Ed Mitchell

1400 The Success of Back to Sleep in SIDS/SUDI and New Challenges (17) *Prof Fern Hauk*

1425 Getting the Safe Sleeping Message to Disadvantaged Groups (18) *Prof Rachel Moon*

1450 Stillbirth in a Historical Context and the Way Forward (19)
Prof Robert Goldenberg

1515 Question Time

1930-2330 Closing Ceremony

The Grand Lodge, Sydney Masonic Centre

Sponsors & Exhibitors

Silver Sponsor

Dragon Trend



Contact name: *Zach Hegde*
Address: *196 Normanby Rd,
Southbank, VIC 3006, Australia*
Phone: *+61 03 9279 4000*
Email: *sales@dragontrend.com*
Website: *www.dragontrend.com*

Dragon Trend specialise in global promotional marketing and products to leading international brands. We are the brand behind Sids & Kids Red Nose Day Campaign, and have been for the last 8 years. We are passionate about philanthropy and at the forefront of innovative fundraising initiatives.

Trust us to help you create a N.F.P Fundraising Campaign that delivers serious returns.

Exhibitors

Halo Innovations



the safer way to sleep®

Contact name: *Bill Schmid*
Address: *111 Cheshire Lane Suite
700, Minnetonka, MN 55305, USA*
Phone: *+1 952 259 1500*
Email: *bill.schmid@haloinnovations.com*
Website: *www.halosleep.com*

HALO is a singular mission to help babies sleep safely. For over 15 years we've been dedicated to developing safe products such as the Halo® SleepSack® wearable blanket and educating parents on safe sleep practices.

US Centers for Disease, Control and Prevention - National Center for Child Death Review

The Partnership to Investigate, Provide Services and Prevent Infant Deaths

*Sudden Unexplained Infant Death Initiative
National Child Death Review Resource Center*



Contact name: *Teri Covington &
Lena Camperlengo*
Address: *Atlanta, Georgia 30341, USA*
Phone: *+1 800 656 2434*

Email: info@childdeathreview.org

Website: www.cdc.gov/sids

Please visit our booth for information on the U.S. SUID Initiative and Child Death Review. We will have information and resources for you on efforts in the U.S. to better investigate, report on and review sudden and unexplained infant death.

Teddy Love Club



Contact name: *Trudi Penrose-Starr*

Address: *Head Office, PO Box 7176, West Lakes SA 5021, Australia*

Phone: *+61 1800 824 240*

Email: *contactus@teddyloveclub.org.au*

Website: *www.teddyloveclub.org.au*

TLC pregnancy and infant loss support is a national support program for bereaved families who experience the loss of their baby to any type of loss before or after birth.



Satchel Sponsor



Name Badge and Lanyard Sponsor



Delegate List Sponsor



Conference Material Sponsor



Memorial Ceremony Supporters



Supported by



This conference is supported by funding from the Australian Government Department of Health and Ageing

Supporting families for over 30 years

A little life, not a little loss

- Support for families
- Listening
- Understanding
- Empathy

Call **13 000 SANDS**

13 000 72637

for support



SANDS
Australia

MISCARRIAGE, STILLBIRTH &
NEWBORN DEATH SUPPORT

www.sands.org.au

